



接头型过滤器 Fitting Type Filters

KL-FT Series

KL-FT Series



产品特点 Features

- ◆ 体积小 Compact design
- ◆ 耐压高 High Pressure
- ◆ 安装容易 Easy to install
- ◆ 易拆卸清洁 Easy to clean

产品规格 Specifications

型号 Model	KL-FT02-S	KL-FT02-L	KL-FT04-L
口径 Port Size	PT 1/4"	PT 1/4"	PT 1/2"
介质 Fluid	压缩空气 Compatible gases		
过滤精度 Filtering Element	20μm	40μm	40μm
最大耐压 Max. Input Pressure	30 bar	100 bar	100 bar
温度范围 Temperature Range	0-80 °C		

外观尺寸 Overall Dimension

◆ KL-FT02-S

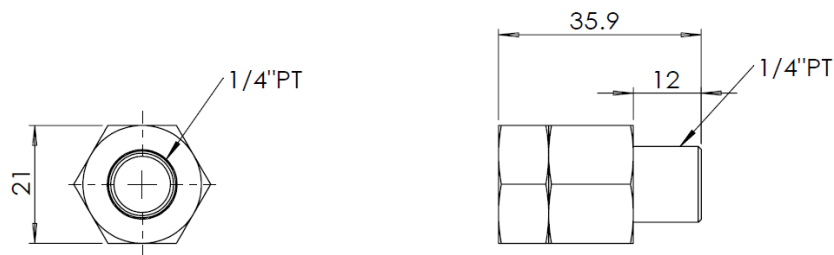

◆ KL-FT02-L

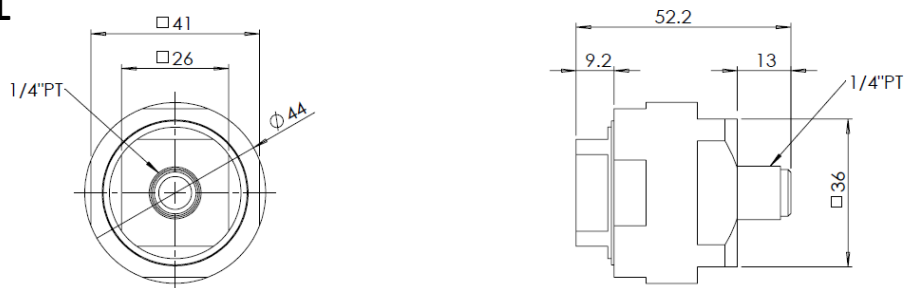

◆ KL-FT04-L

